

LMI Leonard Marr, Inc.

Since 1973

Interlocking Concrete Block Forms

Retaining Walls Security Walls Product Dividers

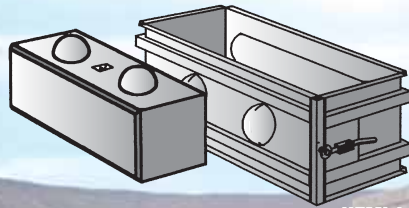

HEMI-LOCK BLOCK

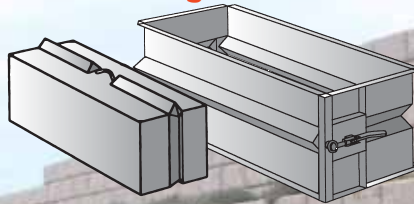

V-LOCK BLOCK

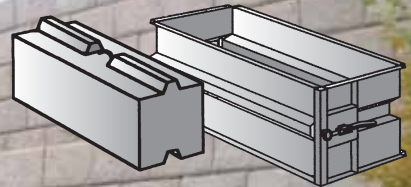

PB-LOCK BLOCK

Parking Barrier Gang Forms



C-101

C-102

C-103

C-104

C-105

**We Also Build
STATE D.O.T.
APPROVED**
(Call for Quotes)

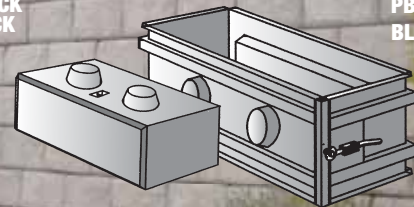
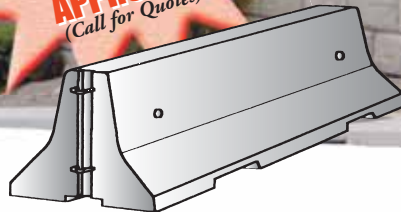

CONE-LOCK BLOCK

Median Traffic Barrier Molds

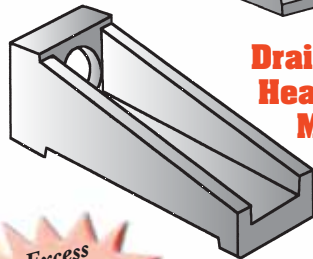

Drainage-Headwall Molds

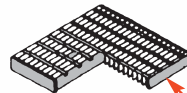

Frame & Grate



Optional Riser

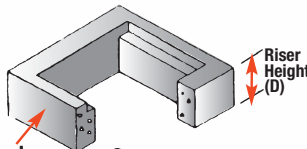

Riser Height (D)

Utility Vault Catch Basin Molds

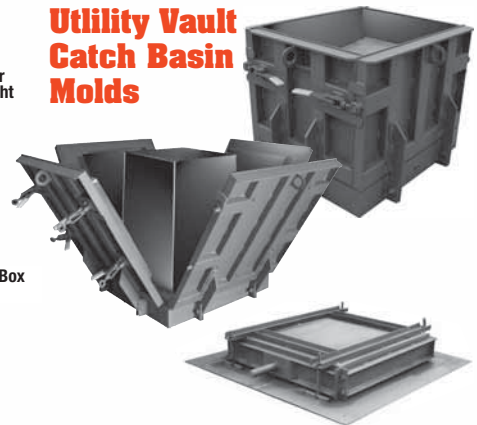

Excess Concrete Molds

Different Style Liners

Thinwall Knockout

Box Width (A)

Box Width (B)

Overall Box Height

PRE-CAST CONCRETE FORMS EQUIPMENT ACCESSORIES

Toll Free **877-511-1234**



www.leonardmarrinc.com

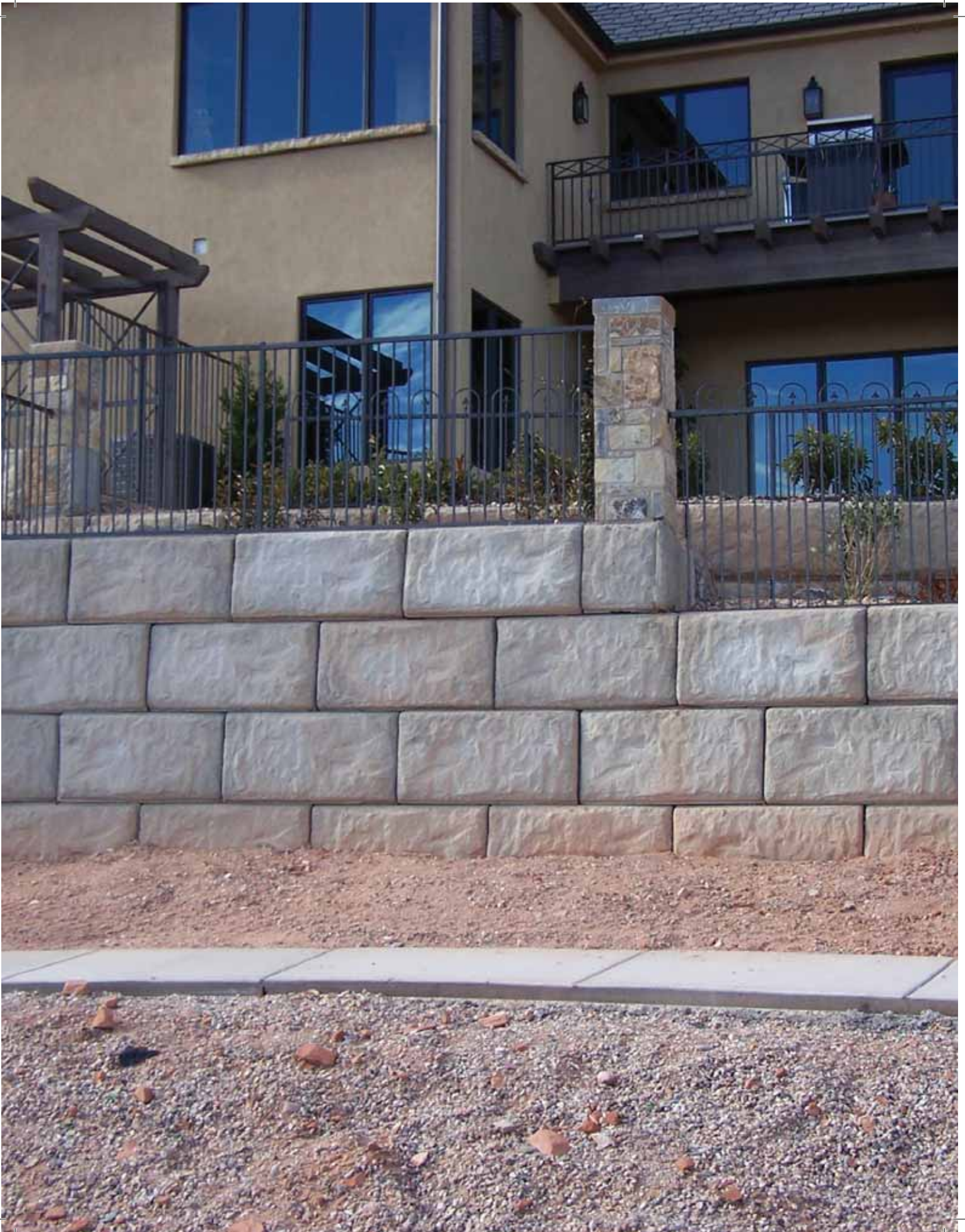

Turn Your Excess Concrete Into An Asset!

Quality Built Interlocking Excess Concrete Block Forms

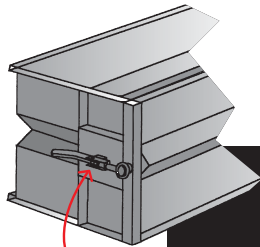
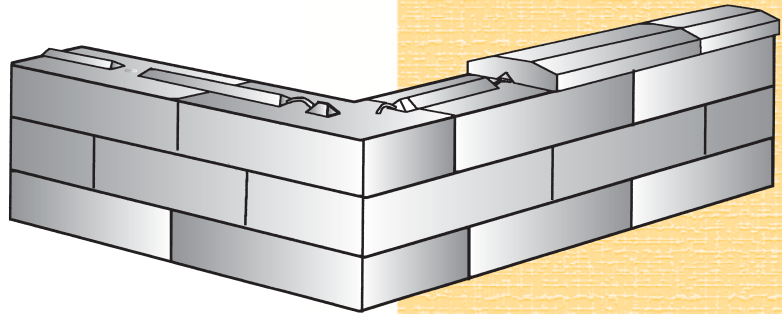

Latch-Type

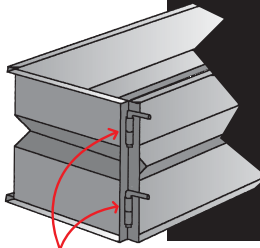

Pin-Type

- Forms built in halves.
- Have pins on corners.
- Easy Fit-Up and Breakdown.
- 10 Gauge Walls - 3/4" Pins.
- Primered and Ready for Use.
- Any size or shape can be constructed at Customer Request.
- Liners available.

V-Lock Block

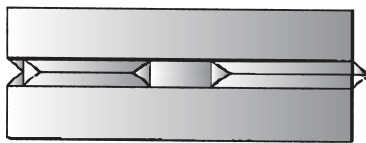

TOP VIEW

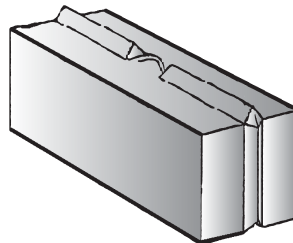

FRONT VIEW

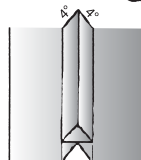

END VIEW

INTER-LOCKING EXCESS CONCRETE BLOCK FORMS

Standard Capacities - Pin Types

1 yd.....(24x24x72)	\$435 ⁰⁰
3/4 yd(24x24x48)	\$420 ⁰⁰
1/2 yd(24x24x36)	\$385 ⁰⁰
1/4 yd(24x24x24)	\$365 ⁰⁰
.....(24x24x18)	\$355 ⁰⁰
.....(18x24x72)	\$410 ⁰⁰
.....(18x24x48)	\$420 ⁰⁰
.....(18x24x36)	\$370 ⁰⁰
.....(18x24x24)	\$355 ⁰⁰
.....(30X30X60).....	\$540 ⁰⁰
.....(30X30X30).....	\$495 ⁰⁰
1 yd.....(36X36X36).....	\$560 ⁰⁰
2 yd.....(36X36X72).....	\$665 ⁰⁰
.....(24x36x72).....	\$640 ⁰⁰
.....(24x36X36).....	\$585 ⁰⁰

Optional

Blank-Outs (lift-eyes).....	\$43 ⁰⁰
Latch-type.....	\$125 ⁰⁰
Stiffeners	\$85 ⁰⁰
Dividers.....	\$110 ⁰⁰

Versatile / Corner Block Molds

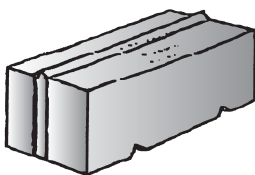

Versatile

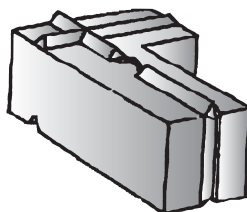

L-Shape Corner

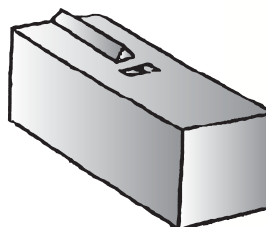

Corner

Corners

L-shape (24x72x36).....	\$980 ⁰⁰
CR-T100 (24x24x72).....	\$690 ⁰⁰
CR-T200 (24x24x60).....	\$680 ⁰⁰
CR-100 (24x24x72).....	\$510 ⁰⁰
CR-200 (24x24x60).....	\$475 ⁰⁰
VT2-100..... (24x24x72).....	\$530 ⁰⁰



Wall & Landscape Hemi-Lock Block

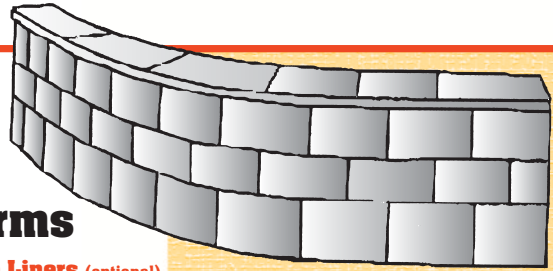

Interlocking Concrete Block Forms

Straight Blocks • Radius Blocks • Corners • Caps • Decorative Liners (optional)

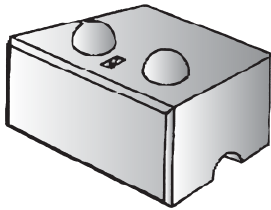

Radius Block
(Tapered Sides)

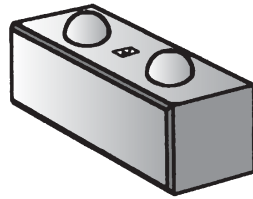

Straight Block

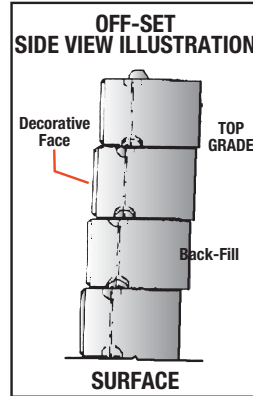

Straight or Radius Blocks

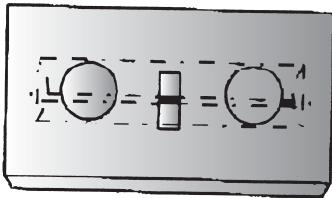

Beveled/Decorative Face
(Optional)
TOP-VIEW

LOCKS
(Hemispherical)

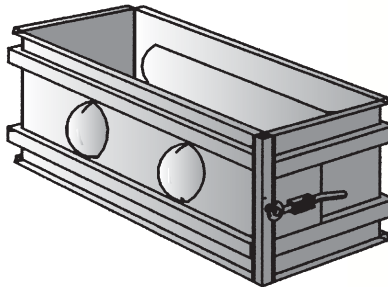

STACK BLOCK VERTICAL
OR OFF-SET

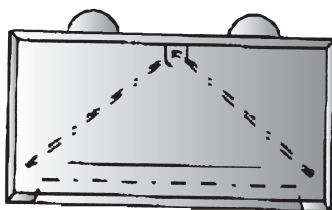

FRONT-VIEW

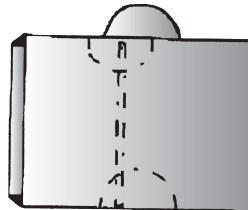

SIDE-VIEW

CAP MOLDS

Straight • Inserts • Reversible • Dividers

Standard Capacities-Pin Type

Hm-2448-24. (24x24x48)	\$685 ⁰⁰
Hm-2472-24. (24x24x72)	\$785 ⁰⁰
Hm-2424-24. (24x24x24)	\$485 ⁰⁰
Hm-3048-24. (24x30x48)	\$875 ⁰⁰
Hm-3072-24. (24x30x72)	\$975 ⁰⁰

Hm-2448-18. (18x24x48)	\$685 ⁰⁰
Hm-2472-18. (18x24x72)	\$785 ⁰⁰
Hm-2424-18. (18x24x24)	\$485 ⁰⁰
Hm-3048-18. (18x30x48)	\$875 ⁰⁰

Hm-3060-30. (30x30x60)	\$820 ⁰⁰
Hm-3030-30. (30x30x30)	\$695 ⁰⁰

Hm-3672-36. (36x36x72)	\$1250 ⁰⁰
Hm-3636-36. (36x36x36)	\$1100 ⁰⁰
Hm-3672-24. (24x36x72)	\$1200 ⁰⁰
Hm-3636-24. (24x36x36)	\$1050 ⁰⁰

Optional

Blank-outs (lift-eyes)	\$43 ⁰⁰
Latch-type	\$125 ⁰⁰

Tapered Side Inserts

Hm-2420-T3. (3" Taper)	\$165 ⁰⁰
Hm-2440-T3. (3" Taper)	\$195 ⁰⁰
Recessed Top Insert	\$285 ⁰⁰
Dividers	\$130/ \$265 ⁰⁰

Corners

L-Risers	\$280/ \$495 ⁰⁰
----------------	----------------------------

Cap Molds

Hm-Cap-2472-8(26x72x8h)	\$680 ⁰⁰
Hm-Cap-2448-8(26x48x8h)	\$640 ⁰⁰
Hm-Cap-2424-8(26x24x8h)	\$420 ⁰⁰

Cap Inserts/Dividers

Hm-Cap-DL-2472-8 (24x72x8)	\$290 ⁰⁰
Hm-Cap-DL-2448-8 (24x48x8)	\$270 ⁰⁰
Hm-Cap-DS-24-8 .. (26x8)	\$110 ⁰⁰



Security-Lock Block PB-Block Block

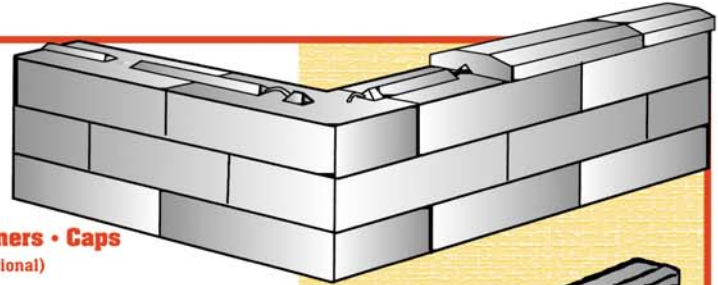

Interlocking Block Molds

Security Walls • Retaining • Straight Blocks • Corners • Caps
Inter-Locking Ends (optional) • Decorative Liners (optional)

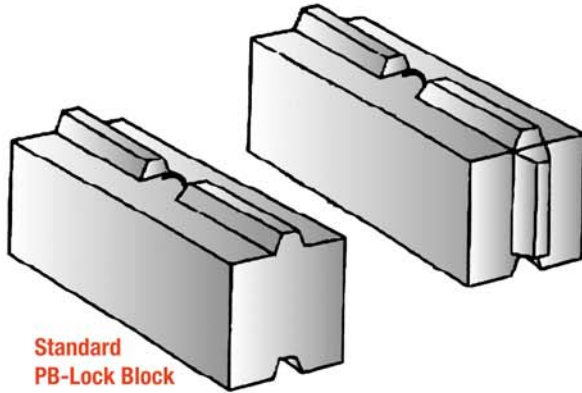

Standard
PB-Block Block

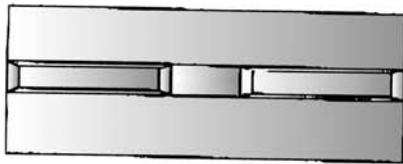
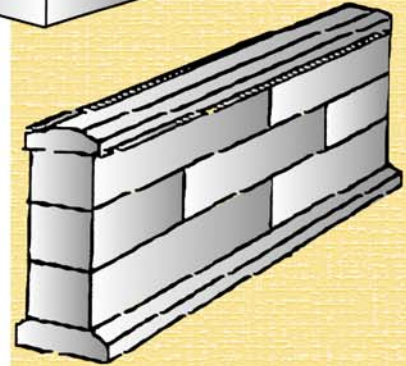
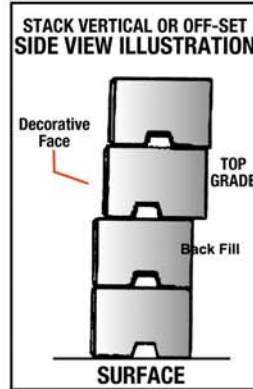

TOP-VIEW

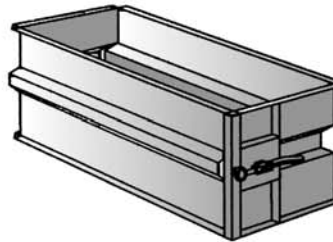

Stack Vertical or Off-Set



FRONT-VIEW

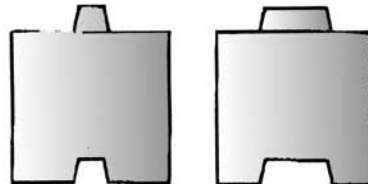

(A)-Block (B)-Block
SIDE-VIEW

Standard (A) Pin-Type

PB-2448-24 ..(24x24x48)	\$585 ⁰⁰
PB-2472-24 ..(24x24x72)	\$685 ⁰⁰
PB-2424-24 ..(24x24x24)	\$385 ⁰⁰
PB-3048-24 ..(24x30x48)	\$775 ⁰⁰
PB-3072-24 ..(24x30x72)	\$875 ⁰⁰

PB-1872-18 ..(18x18x72)	\$580 ⁰⁰
PB-1836-18 ..(18x18x36)	\$525 ⁰⁰
PB-2448-18 ..(18x24x48)	\$585 ⁰⁰
PB-2472-18 ..(18x24x72)	\$685 ⁰⁰
PB-2424-18 ..(18x24x24)	\$385 ⁰⁰
PB-3048-18 ..(18x30x48)	\$775 ⁰⁰

PB-3060-30 ..(30x30x60)	\$720 ⁰⁰
PB-3030-30 ..(30x30x30)	\$595 ⁰⁰

PB-3672-36 ..(36x36x72)	\$950 ⁰⁰
PB-3636-36 ..(36x36x36)	\$800 ⁰⁰
PB-3672-24 ..(24x36x72)	\$900 ⁰⁰
PB-3636-24 ..(24x36x36)	\$750 ⁰⁰

Corner Molds

L-Shape	(24x72x36)	\$1150 ⁰⁰
PB-CR-T	(24x24x72)	\$925 ⁰⁰
PB-CR-T	(24x24x60)	\$890 ⁰⁰
PB-CR	(24x24x72)	\$1050 ⁰⁰
PB-CR	(24x24x60)	\$825 ⁰⁰
PB-VT2	(24x24x72)	\$805 ⁰⁰
PB-VT2	(24x24x48)	\$705 ⁰⁰

Cap Molds

PB-Cap-2472-8(24x24x72)	\$680 ⁰⁰
PB-Cap-2448-8(24x24x48)	\$640 ⁰⁰
PB-Cap-2424-8(24x24x24)	\$420 ⁰⁰

Cap Inserts/Dividers

PB-Cap-DL-2472-8(24x72x8)	\$290 ⁰⁰
PB-Cap-DL-2448-8(24x48x8)	\$270 ⁰⁰
PB-Cap-DS-24-8(26x8)	\$110 ⁰⁰

Optional

Blank-outs (lift-eyes)	\$43 ⁰⁰
Latch-type	\$125 ⁰⁰
Recessed Top Insert	\$285 ⁰⁰
Dividers	\$130/ \$265 ⁰⁰

Corners

L-Risers	\$280/ \$495 ⁰⁰
----------------	----------------------------



Wall & Landscape Cone-Lock Block

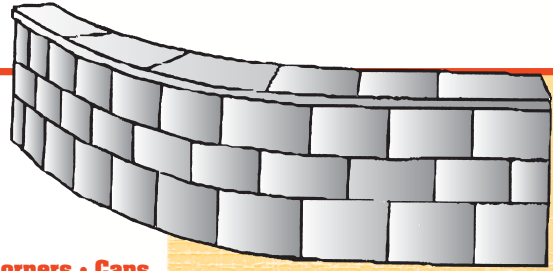

Interlocking Block Molds

Stack Vertical or Off-Set • Straight Blocks • Radius Blocks • Corners • Caps
Versatile Block Mold (optional) • Decorative Liners (optional)

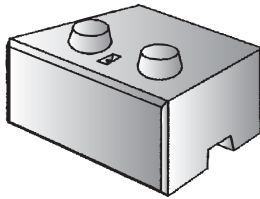

Radius Block
(Tapered Sides)

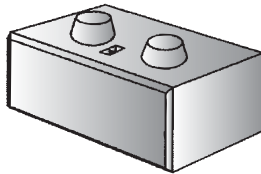

Straight Block

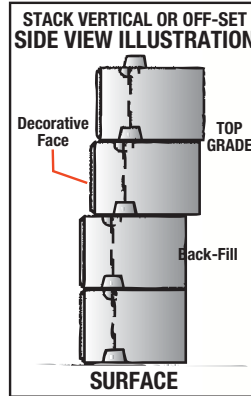

Straight or Radius Blocks

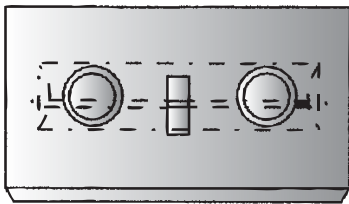

Beveled/Decorative Face
(Optional)
TOP-VIEW

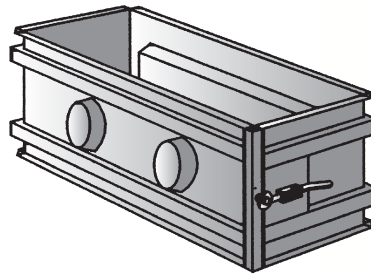

STACK BLOCK VERTICAL
OR OFF-SET

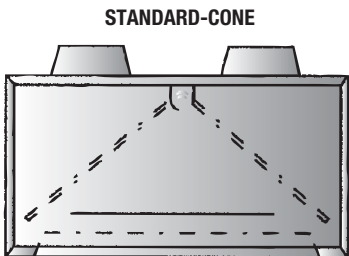

FRONT-VIEW

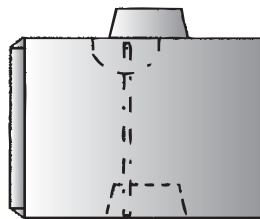

SIDE-VIEW

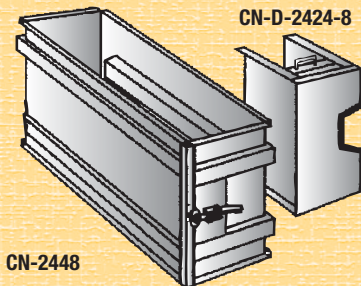

CN-2448

Cap Molds

CN-Cap-2472-8(26x72x8h).....	\$680 ⁰⁰
CN-Cap-2448-8(26x48x8h).....	\$640 ⁰⁰
CN-Cap-R2424-8(26x24x8h).....	\$420 ⁰⁰
CN-Cap-R2448-8(26x48x8h).....	\$650 ⁰⁰

Cap Inserts/Dividers

CN-Cap-D-2436-8(24x36x8).....	\$290 ⁰⁰
CN-Cap-D-2424-8(24x24x8).....	\$270 ⁰⁰
CN-Cap-DS-24-8(26x8).....	\$110 ⁰⁰

Standard Capacities - Pin Type

CN-2448-24..(24x24x48).....	\$710 ⁰⁰
CN-2472-24..(24x24x72).....	\$850 ⁰⁰
CN-2424-24..(24x24x24).....	\$485 ⁰⁰
CN-3048-24..(24x30x48).....	\$950 ⁰⁰
CN-3072-24..(24x30x72).....	\$995 ⁰⁰

CN-2448-18..(18x24x48).....	\$700 ⁰⁰
CN-2472-18..(18x24x72).....	\$830 ⁰⁰
CN-2424-18..(18x24x24).....	\$485 ⁰⁰
CN-3048-18..(18x30x48).....	\$830 ⁰⁰

CN-3060-30..(30x30x60).....	\$685 ⁰⁰
CN-3030-30..(30x30x30).....	\$545 ⁰⁰

CN-3672-36..(36x36x72).....	\$1250 ⁰⁰
CN-3636-36..(36x36x36).....	\$1100 ⁰⁰
CN-3672-24..(24x36x72).....	\$1200 ⁰⁰
CN-3636-24..(24x36x36).....	\$1050 ⁰⁰

Optional

Blank-outs (lift-eyes).....	\$43 ⁰⁰
Latch-type.....	\$125 ⁰⁰

Tapered Side Inserts

Hm-2420-T3. (3" Taper).....	\$165 ⁰⁰
Hm-2440-T3. (3" Taper).....	\$195 ⁰⁰
Recessed Top Insert.....	\$285 ⁰⁰
Dividers.....	\$130/ \$265 ⁰⁰

Corners

L-Risers.....	\$280/ \$495 ⁰⁰
---------------	----------------------------

Inter-Changeable End Panels

CN-PM2424.....(24x24).....	\$220 ⁰⁰
CN-PM2436.....(24x36).....	\$245 ⁰⁰
CN-PM2448.....(24x48).....	\$270 ⁰⁰
CN-PM1824.....(18x24).....	\$210 ⁰⁰
CN-PM1836.....(18x36).....	\$240 ⁰⁰

Mini-Landscaper Block Mold

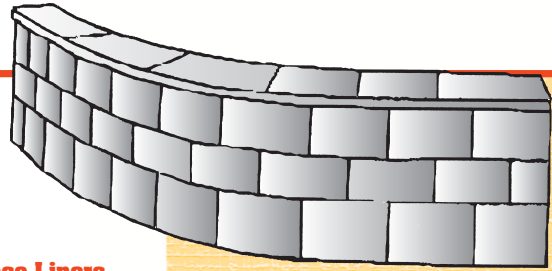

LS (500)

Single Cavity or Gang Unit • Straight or Curved Unit • Rock Face Liners
Corners • Caps

- * Single Cavity \$450⁰⁰
- * Double Cavity \$980⁰⁰
- * Four Cavity \$1450⁰⁰
- * Four Cavity - UT.. \$3100⁰⁰



Gang Molds for Landscape Blocks

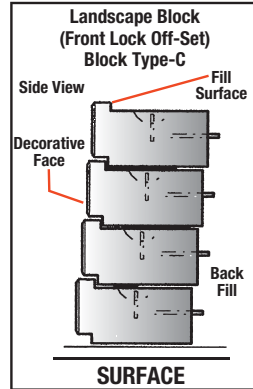

LSG-2412-C4

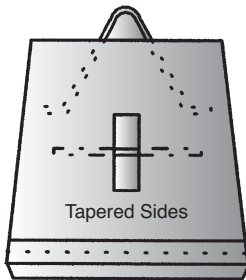

TOP-VIEW

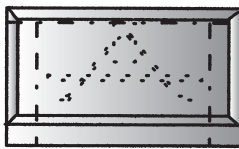

FRONT-VIEW

LS-2412-C

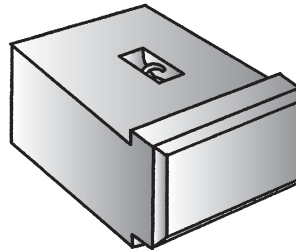

(C-BLOCK)

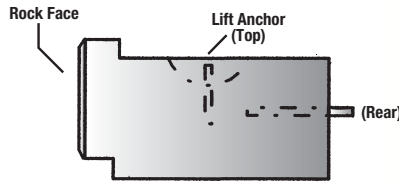

SIDE-VIEW

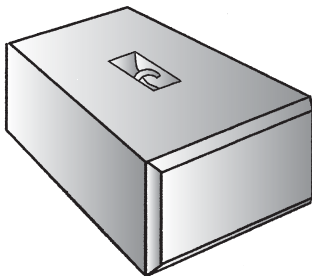

(A-BLOCK)
Flat Surface Block
No Lock

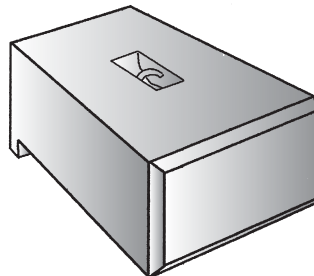

(B-BLOCK)
Flat Surface Block
Off-Set Rear Lock

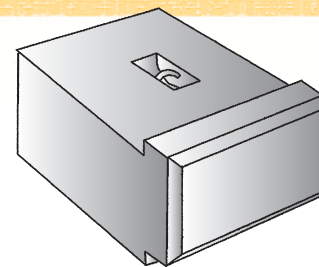

(C-BLOCK)
Raised Face Block
Raised Face Off-Set

Single Cavity Mold

- LS-2412-C1. (24x12x24d) \$450⁰⁰
- Double Cavity \$980⁰⁰

Gang Mold-Four Cavity

- LS-2412-C4. (24x12x24d) \$1450⁰⁰
- Divider \$140⁰⁰

Gang Mold-Four Cavity - UT

- LS-2412-C4. (24x12x24d) \$3100⁰⁰

Decorative Liners

- LS-100 (24x12) \$110⁰⁰
- LS-101 (12x12) \$55⁰⁰
- LS-101-CRN (12x12) \$60⁰⁰

Cap Mold

- LS-CAP-2424R(24x26x6) \$350⁰⁰

Cap Liners

- LS-CAP-100 (2 Pcs) \$95⁰⁰

- Top Res Blankout \$65⁰⁰

- Corner Mold (Single) Left or Right \$450⁰⁰

- Corner Mold (Double) Left or Right ... \$980⁰⁰

- Corner Liner \$60⁰⁰

Decorative Liners

DECORATIVE • DURABLE • URETHANETYP

(use non-solvent release)

*Turn your excess
concrete into an asset!*

**Many Styles
to Choose
From**

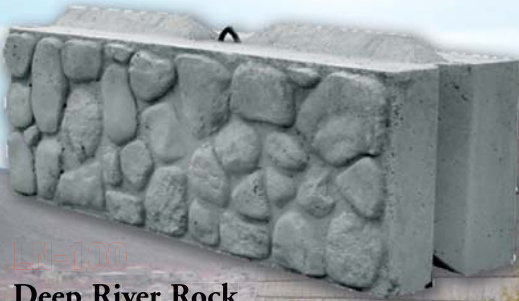

LN-100
Deep River Rock



LN-400
Running Bond
- Limestone 2R



LN-200
Running Bond
- Limestone 3R



LN-500
Ashler

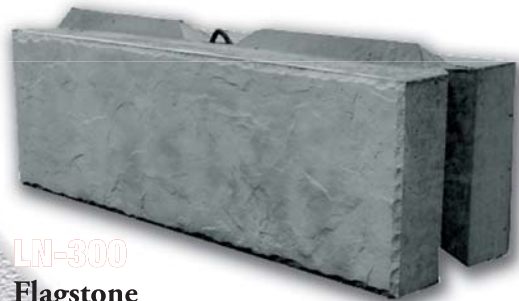

LN-300
Flagstone



LN-700
Lava Rock



LN-800
Dry Stack Ashler



LN-900
Heavy Rock

Main Office/Sales (877) 511-1234



Toll Free Fax (877) 200-4288

Wall Cap Mold Standard Upright

V-BOTTOM DIVIDER-INSERT 45 DEGREE-INSERT

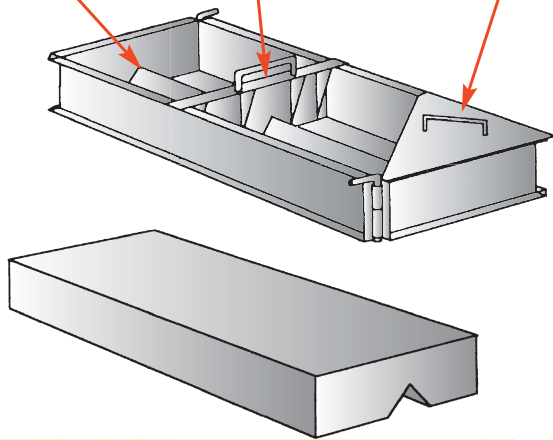

Standard Units:

26x72x10
26x72x8
26x72x6

Optional:

Divider Insert
45 Degree Insert
Latch-Type (One Corner)
Chamfered Sides

Cap & Base Molds Inverted Cap Mold for Decorative Walls

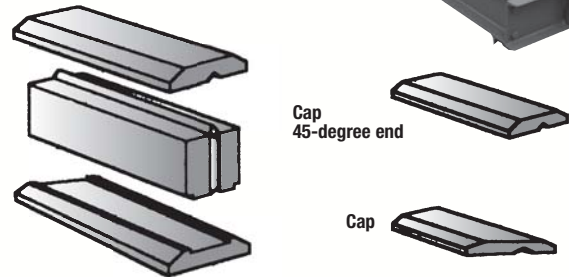

Cap Mold:

- 26 x 72 x 8
- Divider Insert - for making different length
- 45 Degree Insert - makes left and right turn

Inverted Cap Mold
Divider Insert
45 Degree Insert

Utility Vault Catch Basin Molds

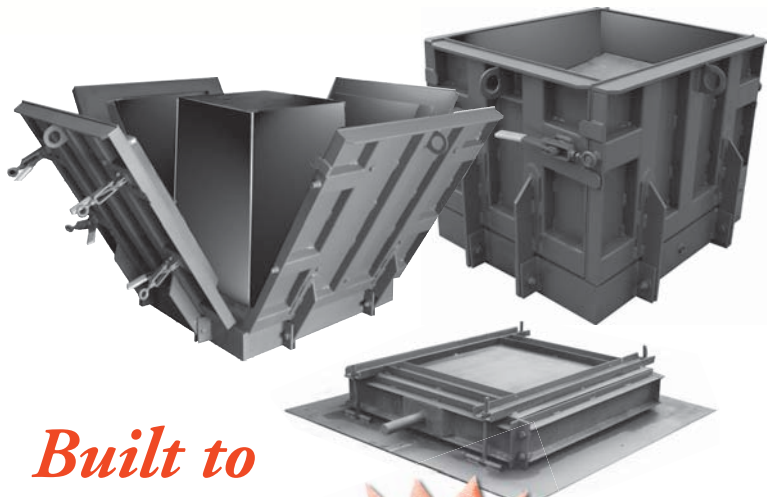
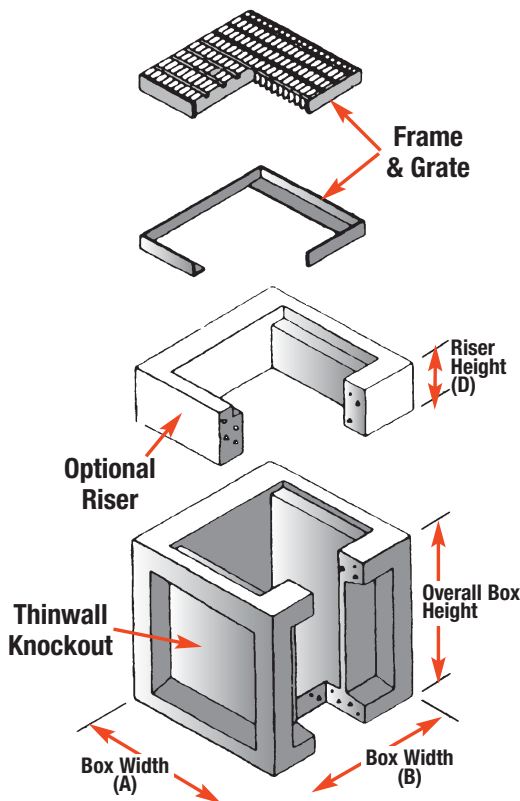

*Built to
Any Size®*



Standard Sizes

Box Size 2 ft.
Box Size 3 ft.
Box Size 4 ft.

OPTIONAL

Knock-Outs / Risers
(Also Grease and
Sand Trap Molds)

Concrete Molds for Portable & Stationary Fencing

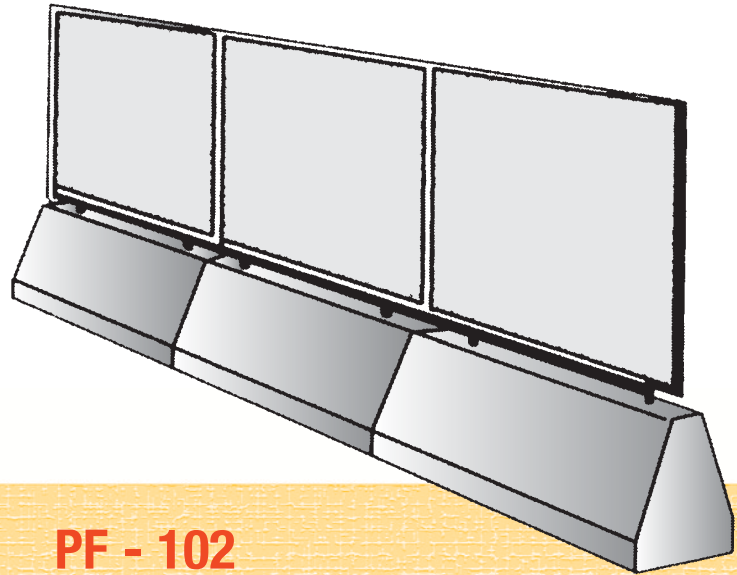

PF - 101

Dimensions:

Base Width
Top Width
Height

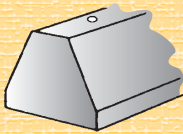

Length:

5 ft.
6 ft.
8 ft.
10 ft.
12 ft.

PF - 102

Dimensions:

Base Width
Top Width
Height

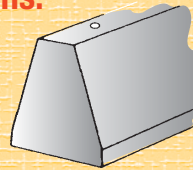

Length:

5 ft.
6 ft.
8 ft.
10 ft.
12 ft.

Quality Built Concrete Wall Molds

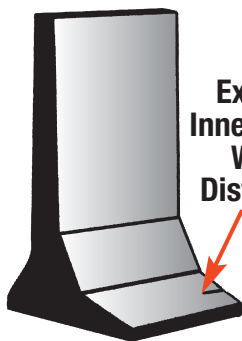

T-Wall Molds

Extended
Inner Leg For
Weight
Distribution

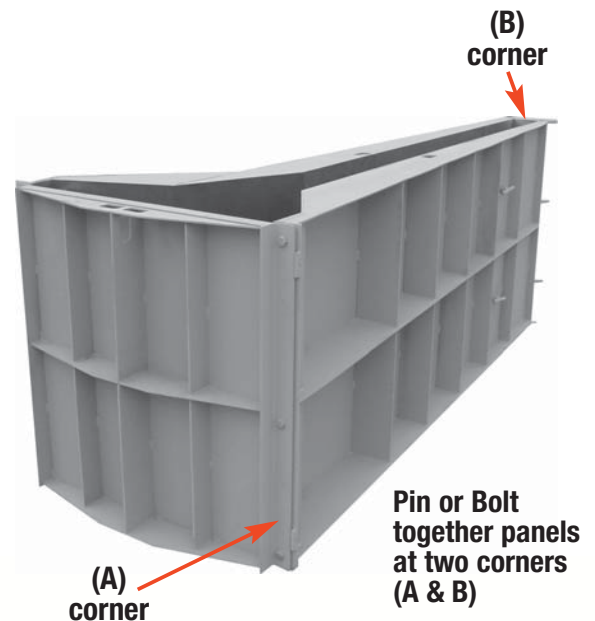
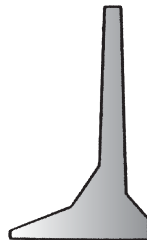
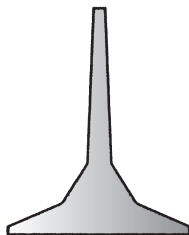

(A) corner

(B) corner

Pin or Bolt
together panels
at two corners
(A & B)

Standard Heights & Widths

Units 72" in Height

WM-24-72 (24" Wide)
WM-36-72 (36" Wide)
WM-48-72 (48" Wide)

Units 120" in Height

WM-24-120 (24" Wide)
WM-36-120 (36" Wide)
WM-48-120 (48" Wide)

Units 96" in Height

WM-24-96 (24" Wide)
WM-36-96 (36" Wide)
WM-48-96 (48" Wide)

Construction

- 10 ga. Steel Panels
- Formed Channel Reinforced
- 1/4" Thick Gusset Reinforced
- Pin or Bolt Together Panels

Quality Built Parking Barrier Forms

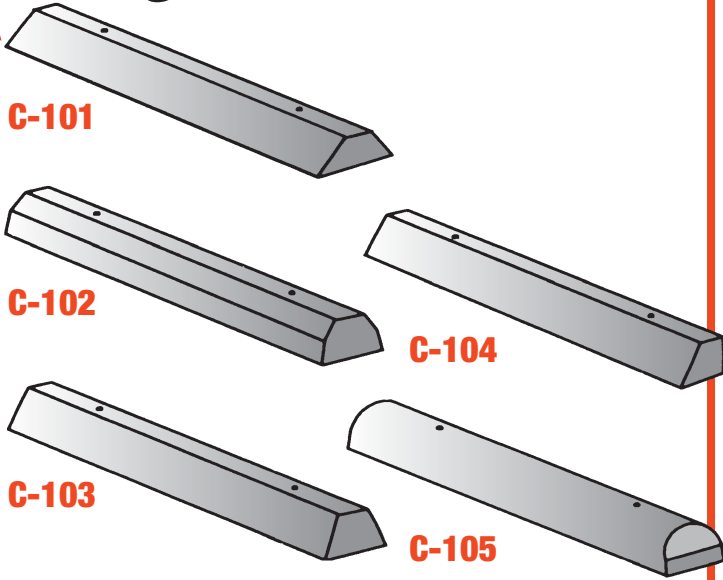

Utility Molds Built to Any Size

- *Quality Built*
- *Heavy Duty*
- *Easy-Strip*

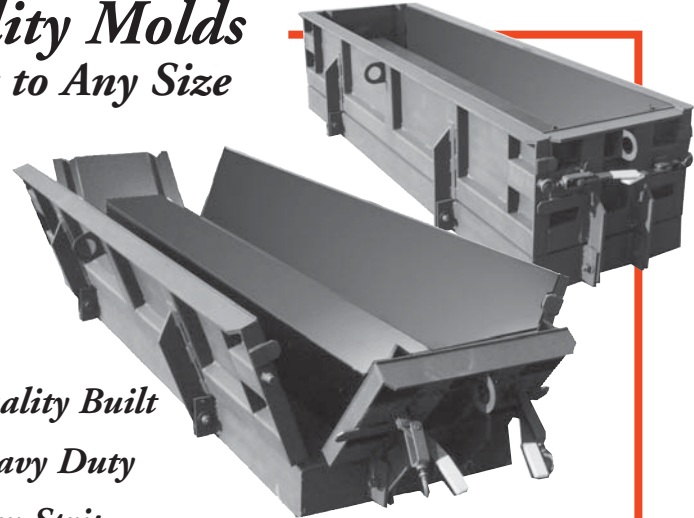

1/4" Side-Walls & Core
Up-Rite/Inverted

- * *Drainage - Catch Basin/Inlets*
- * *Environmental - Containment*
- * *Landscape - Blocks/Planters*
- * *Agricultural (Feeder/Water)*

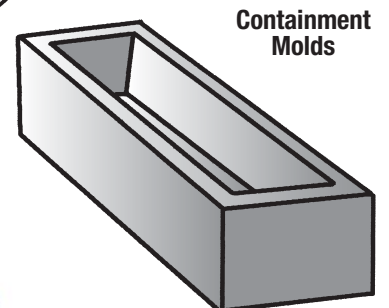
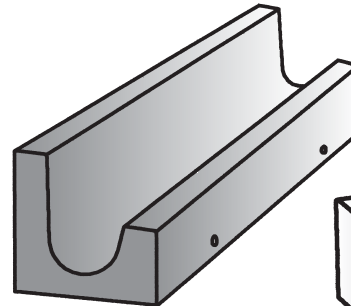
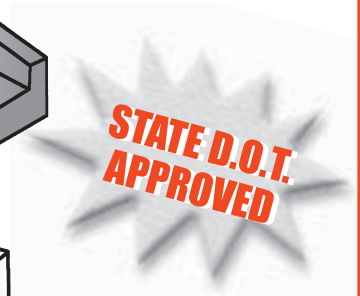
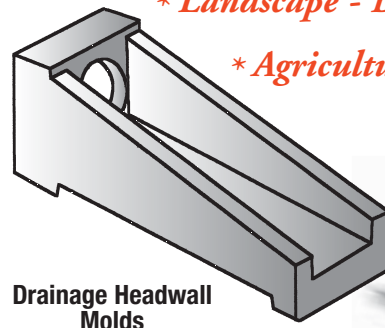

Standard Utility Trench Molds:

- 1' - 0" x 1' - 6" x
(10' - 0" or 20' - 0")
- 1' - 1" x 2' - 0" x 10'
- 2' - 2" x 2' - 0" x 10'
- 2' - 6" x 2' - 6" x 20'
- 3' - 0" x 3' - 6" x 20'

Landscape - Blocks/Planters

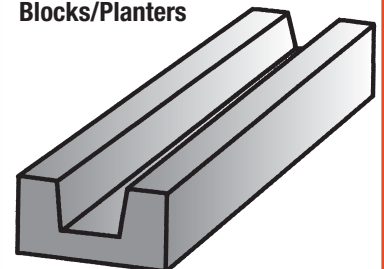

Parking Barrier Forms

Standard Units 72" long

84" Units (Additional)
96" Units (Additional)

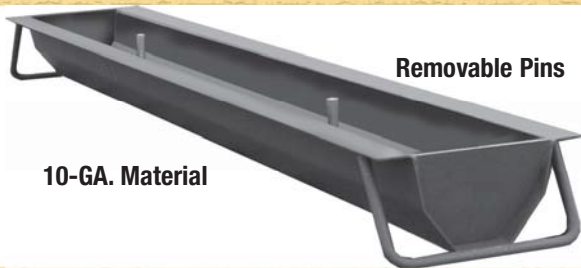

Easy-Strip Gang Molds

Standard Units 72" long

- C-101 (Per Unit in Nest)
- C-102 (Per Unit in Nest)
- C-103 (Per Unit in Nest)
- C-104 (Per Unit in Nest)

Optional -

Upgrade Unit Tapered Pins Latched Slide Bars I-Beam Bottom

84" Units (Additional)
96" Units (Additional)



Median, Traffic, & Security Barrier Molds

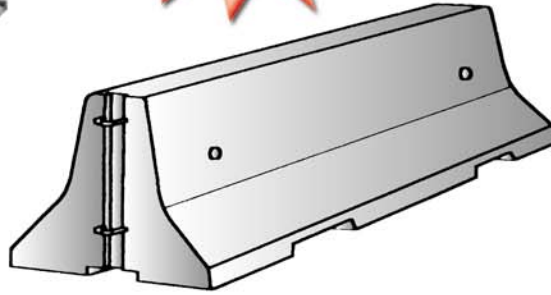

- Type-F (12'x6") \$4800⁰⁰
- Caltrans
 - K-Rail (19'x11") \$8600⁰⁰
 - K-60..... (19'x11") \$8400⁰⁰

Concrete Divider Forms

Standard Units
(casting poured upright)

- 10 ft. (without bottom plate) \$3600⁰⁰
- 8 ft. (without bottom plate) \$3500⁰⁰
- 5 ft. (without bottom plate) \$3400⁰⁰

Inverted Divider Mold

Standard Units
(Single or Double Cavity)

- 10 ft. Base Price \$3800⁰⁰
- 8 ft. Base Price \$3650⁰⁰
- 5 ft. Base Price \$3500⁰⁰

Security Barriers

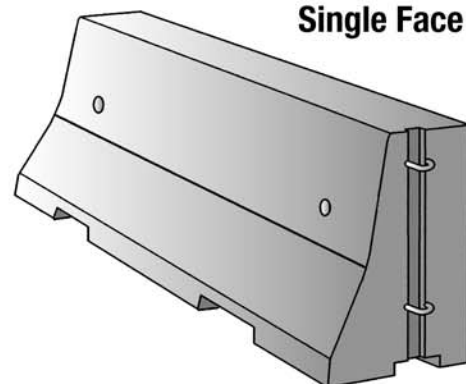
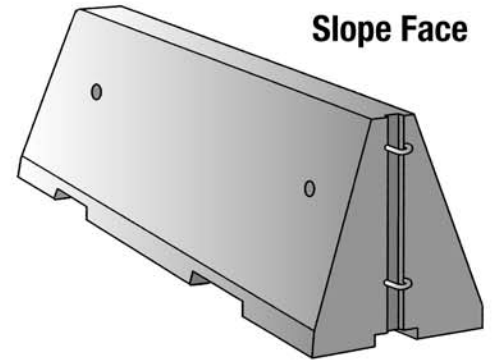
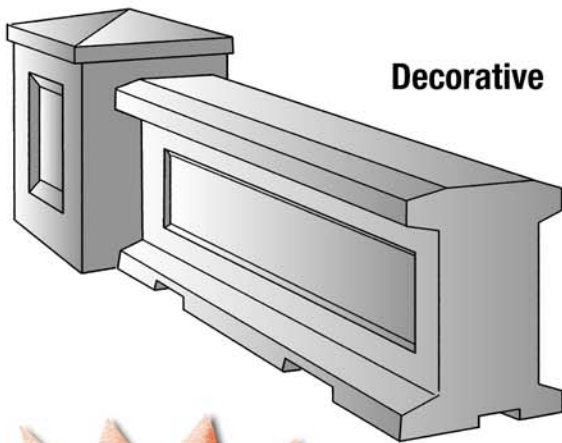

Quality Built • Heavy Duty

*Prices are subject to change without notice

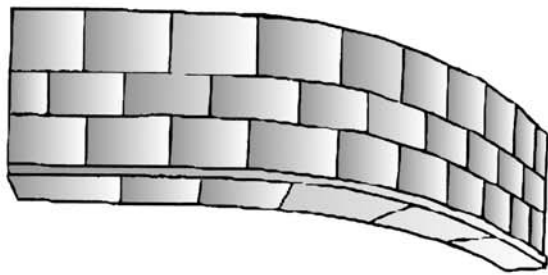

FORMS
Concrete
Built
Quality

P.O. Box 270585
 Flower Mound, TX 75027

Since 1973
LMI
 Leonard
 Marr,
 Inc.